



CT Cart-Small

ASSEMBLY INSTRUCTION SHEET

WE RECOMMEND AT LEAST TWO PEOPLE ASSEMBLE/ADJUST THIS CART

Supply List

Before beginning cart assembly, ensure that all of the following components and fasteners are included in the package.

Parts:

1. Base Assembly
2. Main Handle
3. End Handles (2)
4. 6) 3/8"-16 X 3/4" Socket Head Bolt

Tools Required:

1. 5/16" Hex Wrench (included)

Notes:

1. All bolts should be kept tight for the cart to function properly and to avoid a potentially dangerous situation.

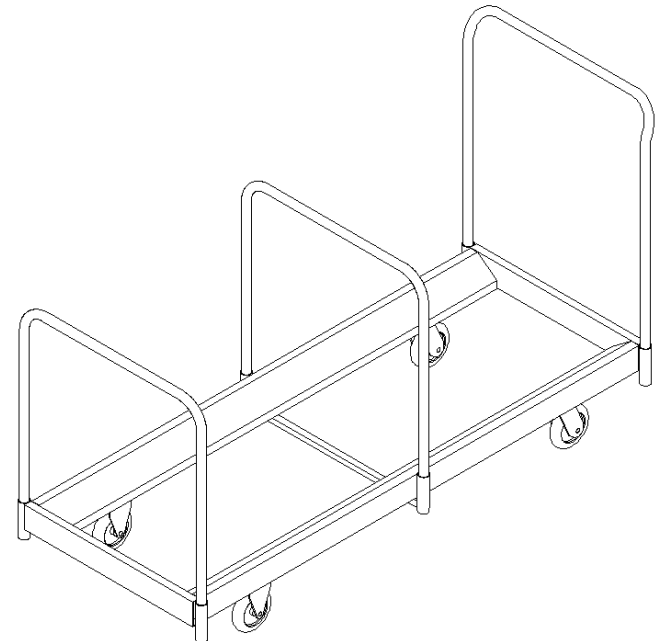
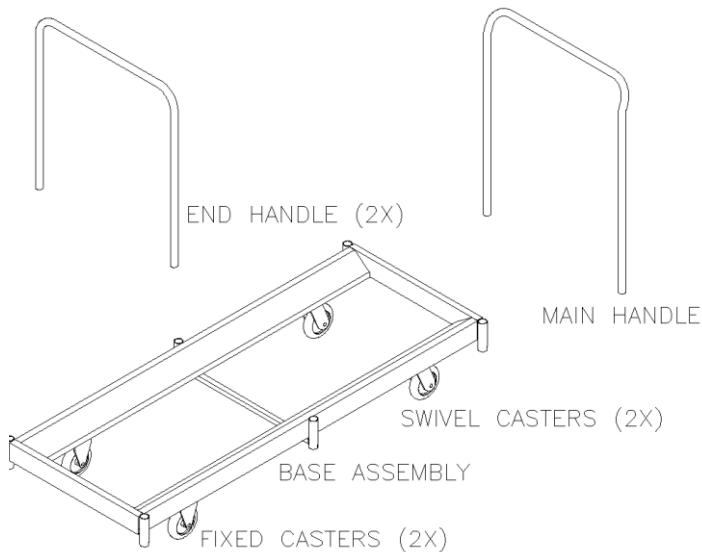
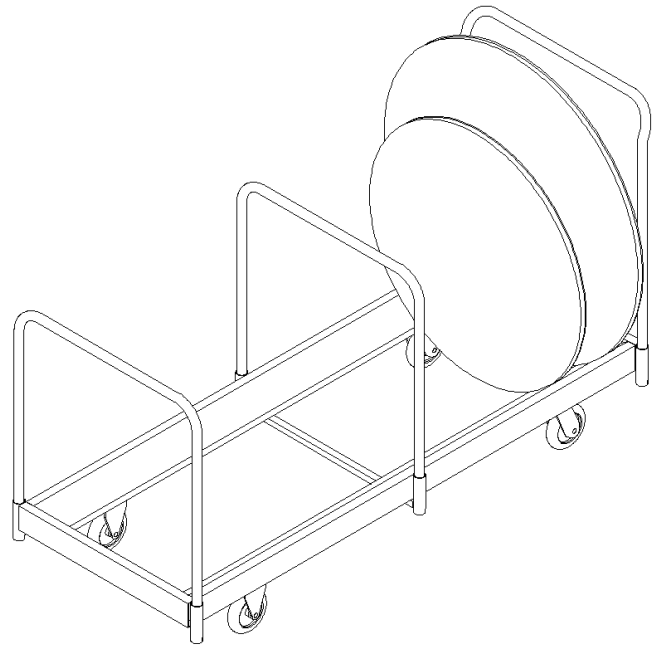

See other side for assembly information

Assembly Instructions

Step:

1. Insert the Main Handle into the sockets on the end of the Base with the swivel casters (See Figure 1). Make sure the handle tilts towards you (See Figure 2).
2. Start the 3/8" X 3/4" socket head bolts into the threaded nut on the sockets (if not already done -See Figure 4). Do not tighten yet.
3. Insert the End Handles into the sockets (See Figure 3).
4. Secure the handles to the Base by using the wrench provided (See Figure 4).

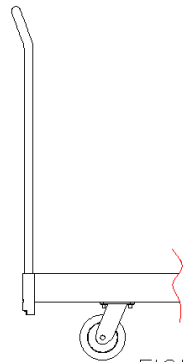

FIGURE 2

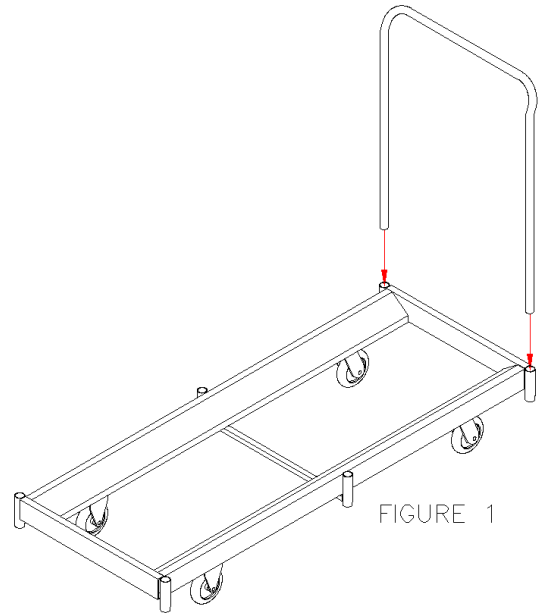

FIGURE 1

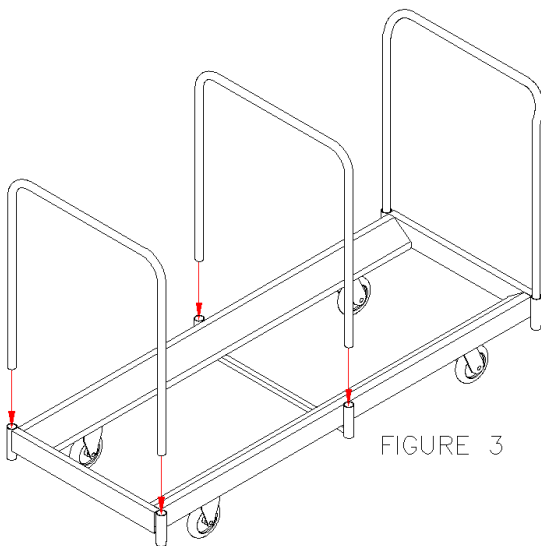

FIGURE 3

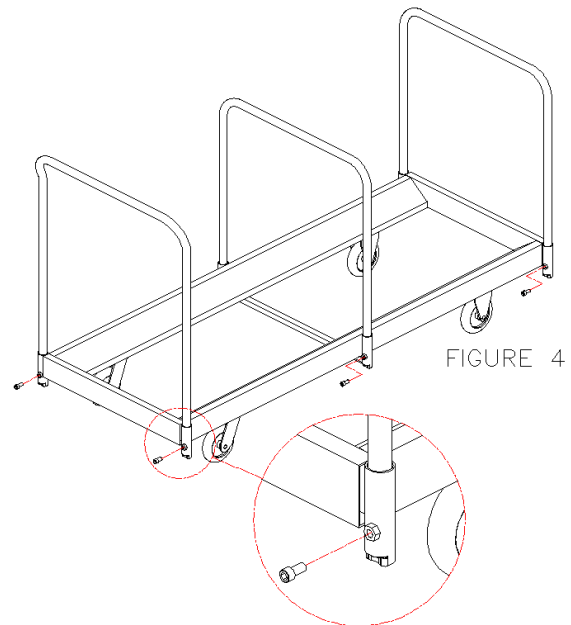

FIGURE 4