



#### Supply List

Before beginning cart assembly, ensure that all of the following components and fasteners are included in the package.

#### Parts:

1. Base Assembly (Narrow or Wide)
2. Main Handle
3. Side Handles (2)
4. Middle Handle (Wide Cart Only)
5. (6) 3/8"-16 X 3/4" Socket Head Bolt (Wide Cart) or  
(4) 3/8"-16 X 3/4" Socket Head Bolt (Narrow Cart)
6. (2) 3/8"-16 X 2" Socket Head Bolt (Full Thread)

#### Tools Required:

1. 5/16" Hex Wrench (included)

#### Notes:

1. These instructions are used for both versions of the CT Edge Cart.
2. All bolts should be kept tight for the cart to function properly and to avoid a potentially dangerous situation.
3. We recommend that two people assemble this cart.

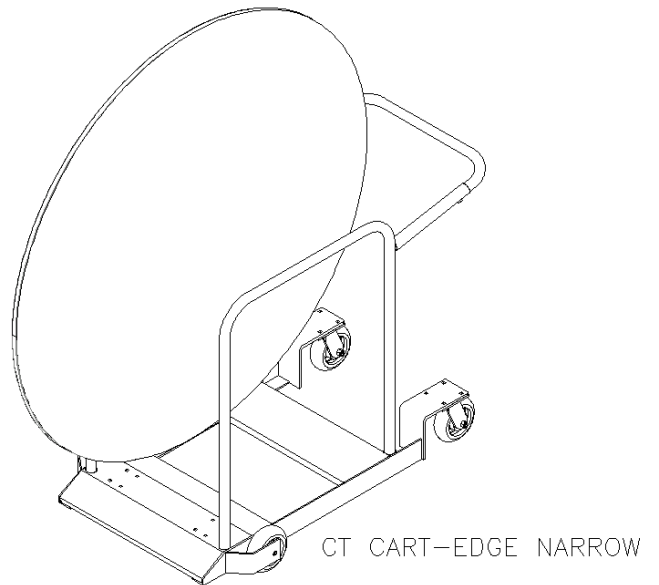
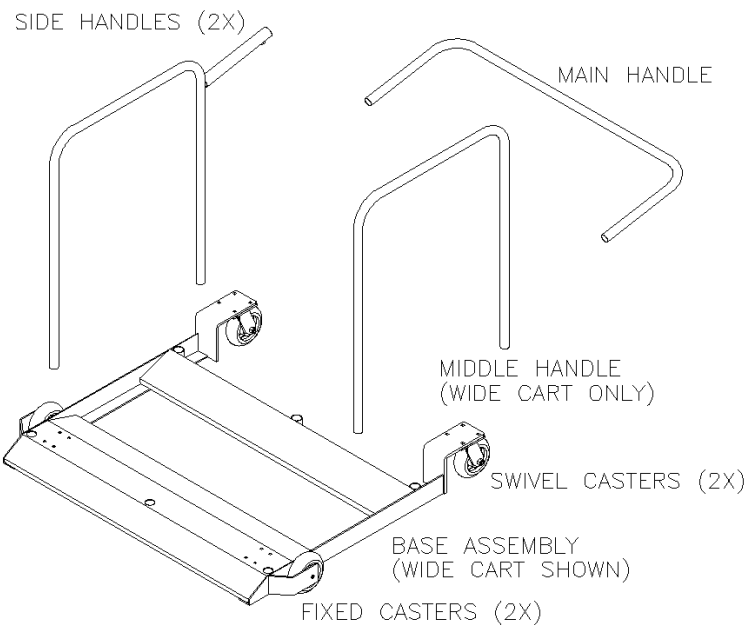
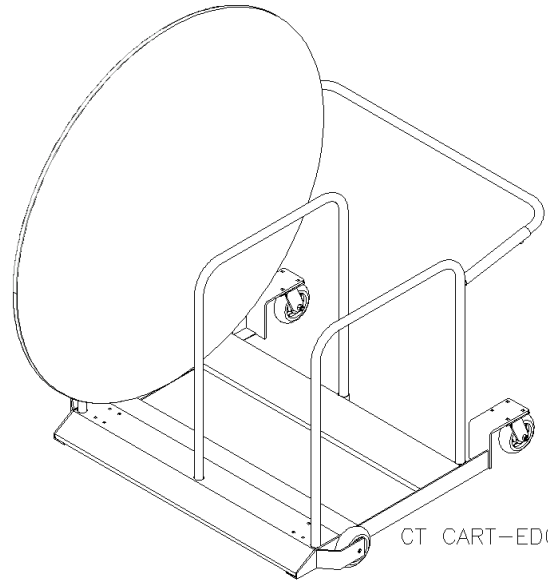

See other side for assembly information

## Assembly Instructions

### Step:

1. Insert the Side Handles into the sockets on the inside edge of the Base (See Figure 1).
2. Start the 3/8" X 3/4" socket head bolts & 3/8" X 2" bolts into the threaded nut on the sockets (if not already done - See Figure 4). The cart will need to be tipped on its side to access the front sockets. Do not tighten yet.
3. If assembling the wide version of this cart, insert the Middle Handle into the sockets located in the center of the cart (See Figure 2).
4. Insert the Main Handle into the Side Handle sockets (See Figure 3). The holes in the Main Handle MUST face down. Align the holes of the Side Handle sockets with the holes in the Main Handle.

*NOTE: There are two sets of holes in the Main Handle which allow the handle to adjust to accommodate both large and medium sized round tables.*

5. Once holes are aligned, insert the 3/8" X 2" bolt into the socket. The bolt should thread most of the way into the socket (See Figure 3, Detail A).

*NOTE: If the bolt threads partially into the socket, it may allow the Main Handle to slip out of the socket resulting in a potentially dangerous situation.*

6. Secure the handles to the Base by using the wrench provided (See Figure 4).

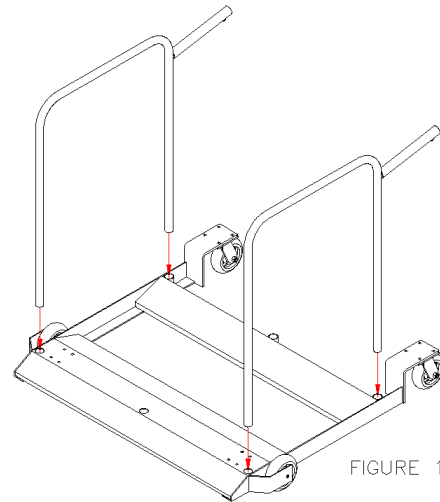

FIGURE 1

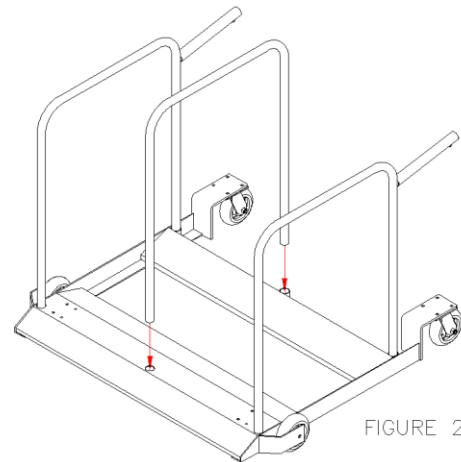

FIGURE 2

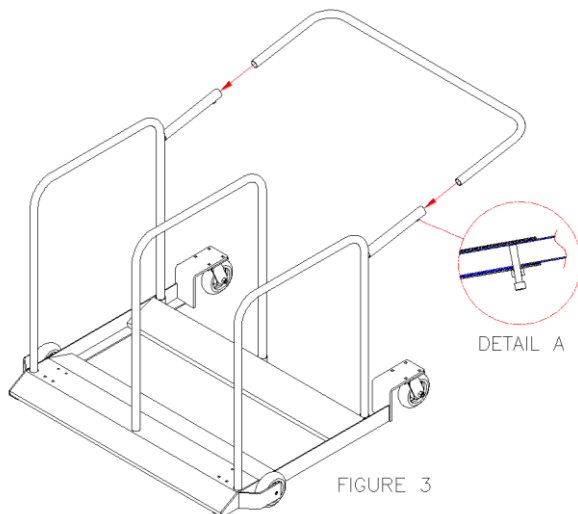

FIGURE 3

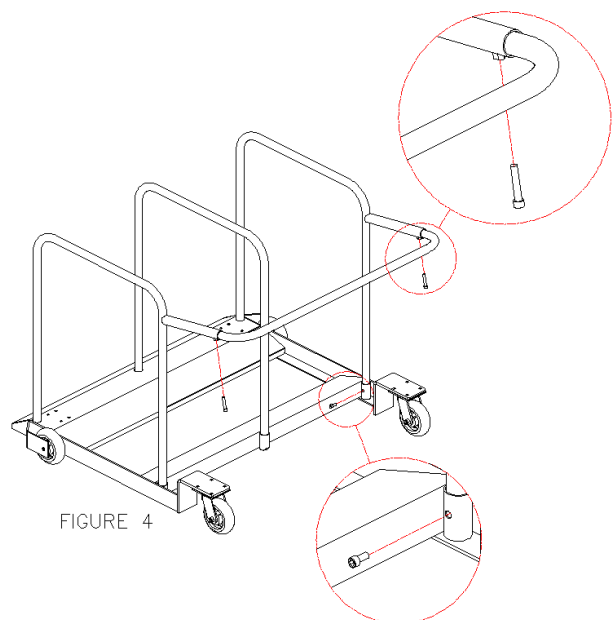

FIGURE 4