



High Capacity Cart-Push

ASSEMBLY INSTRUCTION SHEET

WE RECOMMEND AT LEAST TWO PEOPLE ASSEMBLE/ADJUST THIS CART

Supply List

Before beginning cart assembly, ensure that all of the following components and fasteners are included in the package.

Parts:

1. Handle Assembly with Straps (2)
2. Base Assembly
3. Swivel Caster (2)
4. Fixed Caster (2)
5. Hitch (Optional)
6. (16) 5/16"-18 X 1" Carriage Bolt
7. (16) 5/16" Nyloc Nut
8. (16) 5/16" Flat Washer
9. (4) 3/8"-16 X 3/4" Socket Cap Screw

Tools Required:

1. 1/2" Wrench/Ratchet & Socket (not included)
2. 5/16" Hex Wrench (not included)

Notes:

1. DO NOT tighten bolts until cart is completely assembled, this allows for adjustment, if necessary.
2. This cart requires a forklift to transport, unless equipped with Hitch (optional).
3. Works with MityLite's Comfort Seating Cart-4 Wheel.
4. Swivel casters MUST be installed on the Hitch Side of the cart.

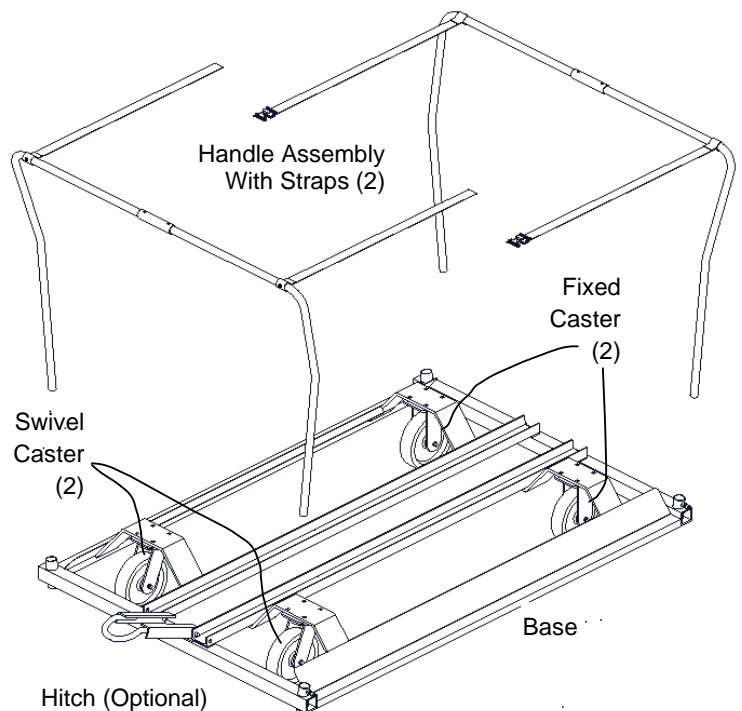
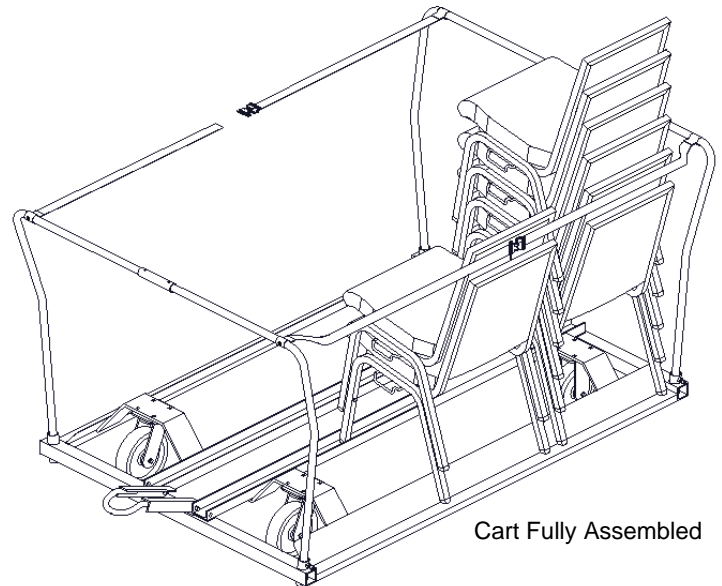

Assembly Instructions

Step:

1. Make sure the cart is on a flat, level surface.
2. Insert Handle Assembly into sockets on cart Base (See Figure 1).
3. Repeat for the other end of the cart (See Figure 2).
4. Tighten all socket bolts (See Figure 3, Detail A).

