

**Supply List**

Before beginning cart assembly, ensure that all of the following components and fasteners are included in the package.

**Parts:**

1. Bottom Crossbar
2. Rung Crossbar (3)
3. End Upright (2)
4. Handle
5. (16) 5/16"-18 X 2 1/2" Hex Bolts
6. (40) 5/16" Flat Washers
7. (24) 5/16"-18 Nyloc Nuts
8. (2) 6" Fixed Casters
9. (2) 6" Swivel Casters

**Tools Required:**

1. 1/2" Wrench/Ratchet & Socket (not included)

**Notes:**

1. We recommend at least two people assemble this cart.
2. These instructions are used for both versions of the tree cart.
3. DO NOT tighten bolts until cart is completely assembled, this allows for adjustment, if necessary.
4. Load chairs so that the top of the chair points toward the handle end of the cart. For Mesh-One & Flex-One, load the chairs with front of backrest facing in (logo out) & top of seat facing out (logo in) for maximum load density.
5. ALWAYS load bottom rows of cart first, alternating each side to evenly distribute weight.

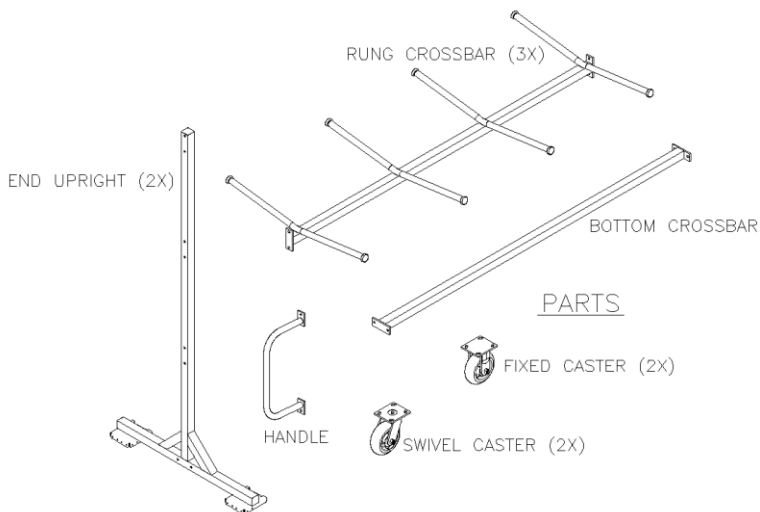
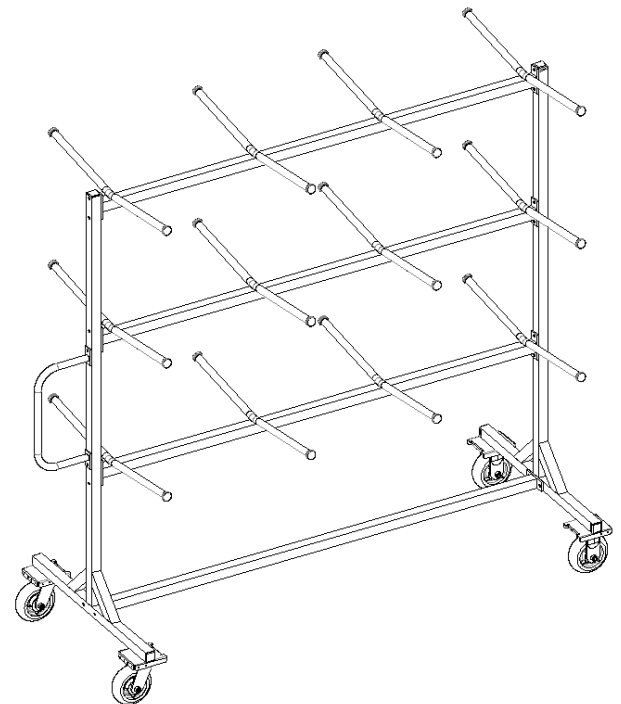
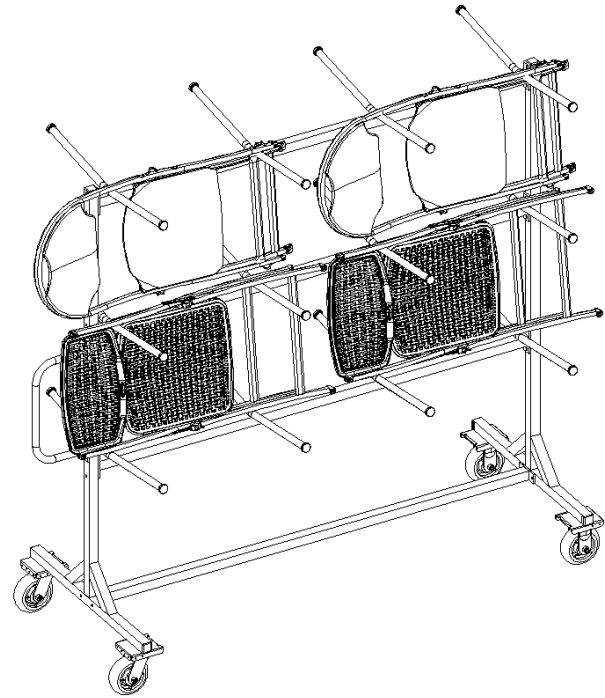

See other side for assembly information

### Assembly Instructions

#### Step:

**NOTE:** It is easier to assemble the cart before installing the casters. We recommend that at least two people assemble this cart.

1. Orient the End Uprights so that the tab on the caster pad faces in towards the center of the cart (See Figure 1, Detail A). Attach the Bottom Crossbar to the End Uprights (See Figure 1, Detail A) using 2 1/2" long, 5/16" hex bolts, washers, and nyloc nuts. Hand tighten.
2. Attach the top Rung Crossbar to the End Uprights (See Figure 2, Detail B) using 2 1/2" long, 5/16" hex bolts, washers, and nyloc nuts. Hand tighten.
3. Attach the 2nd and 3rd Rung Crossbar to one End Upright of the cart (See Figure 3, Detail C) using 2 1/2" long, 5/16" hex bolts, washers, and nyloc nuts. Hand tighten. This will be the fixed caster end.
4. Attach the 2nd and 3rd Rung Crossbar to the other End Upright using 2 1/2" long, 5/16" hex bolts, washers, and nyloc nuts. Attach ONLY TOP bolt on the 2nd Rung Crossbar & ONLY BOTTOM bolt on the 3rd Rung Crossbar (See Figure 3, Detail D). Hand tighten. This will be the swivel caster/handle end.
5. Attach the Handle to the End Upright (See Figure 4, Detail E) using 2 1/2" long, 5/16" hex bolts, washers, and nyloc nuts. Hand tighten.
6. Tighten all bolts.
7. Attach the casters (See Figure 5 for caster installation instructions). Tighten.

